

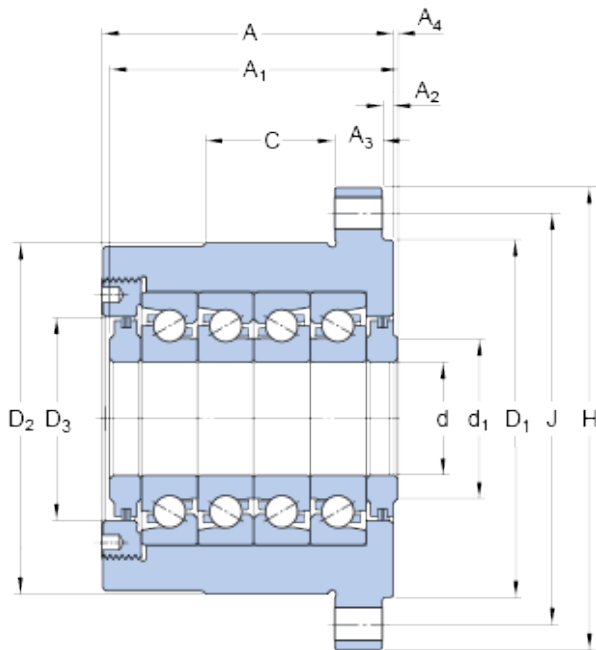

Jinan Kaiming Bearing Co., Ltd.

SKF FBSA 210 A/QBC thrust ball bearings

Bearing No. FBSA 210 A/QBC



FBSA 210 A/QBC Bearing 2D drawings and 3D CAD models

Size	50x165x106 mm
Bore Diameter	50 mm
Outer Diameter	165 mm
Width	106 mm
d	50 mm
H	165 mm
A	106 mm
A ₁	106.26 mm
A ₂	4 mm
A ₃	24 mm
A ₄	1 mm
C	35 mm
d ₁	66 mm
D ₁	128 mm
D ₂	128 mm
D ₃	76 mm
Basic dynamic load rating - C	75.8 kN
Basic static load rating - C ₀	292 kN
Fatigue load limit - P _u	10.8 kN
Limiting speed, Preload class A	3000 r/min
Limiting speed for oil lubrication	1500 mm/min
Preload class A	8200 N
Preload class B	16400 N



Jinan Kaiming Bearing Co., Ltd.

Frictional moment, Preload class A	0.62 N · m
Frictional moment, Preload class B	1.36 N · m
Static Axial rigidity, Preload class A	2820 N/micron
Static Axial rigidity, Preload class B	3600 N/micron
A ₁	106.26 mm
A ₂	4 mm
A ₃	24 mm
A ₄	1 mm
d ₁	66 mm
D ₁	128 mm
D ₂	128 mm
D ₃	76 mm
Basic dynamic load rating C	75.8 kN
Basic static load rating C ₀	292 kN
Fatigue load limit P _u	10.8 kN
Attainable speed for preload class A	3000 r/min
Attainable speed for preload class B	1500 r/min
Frictional moment for preload class A	0.62 N · m
Frictional moment for preload class B	1.36 N · m
Static axial stiffnes for preload class A	2820 N/ μ m
Static axial stiffnes for preload class B	3600 N/ μ m
Mass cartridge unit	9.3 kg
Through hole diameter for attachment bolts N	11.4 mm
Pitch diameter of attachment bolt holes J	146 mm



Jinan Kaiming Bearing Co., Ltd.

Cartridge half diameter without flange J ₁	65.5 mm
Threaded hole size G	M10x1,5